

# OsteoCentric SI-Fusion

## Integrity-SI<sup>®</sup> Fusion System

---

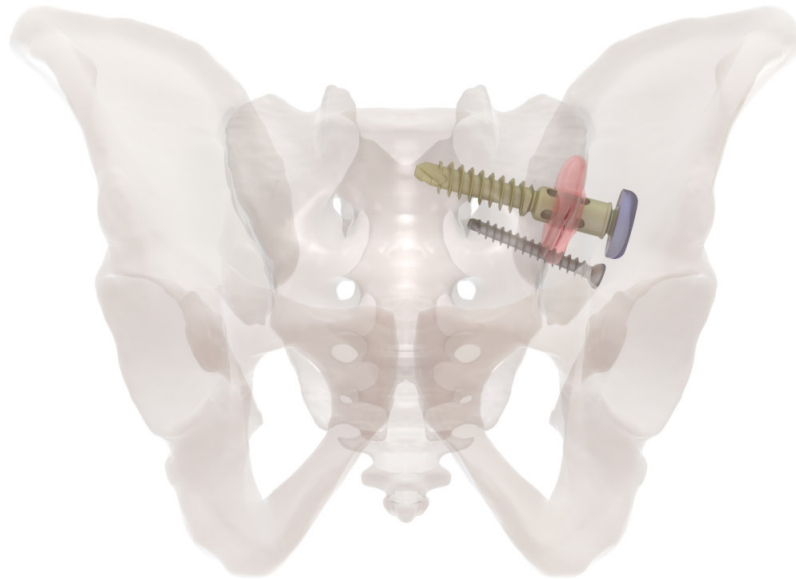

Featuring BladeX<sup>®</sup> and UnifiMI Technology

### BladeX<sup>®</sup>

BladeX allows surgeons to aggressively decorticate the SI joint - creating a massive zone for fusion to occur.



BladeX<sup>®</sup> MIS Decorticator



### UnifiMI

An OsteoCentric Technology

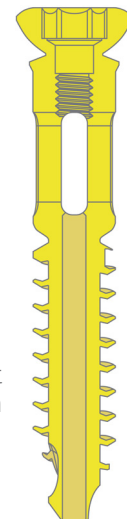

Integrity-SI Fusion Implant  
Cross Section



**OsteoCentric**  
SI FUSION

## Design Rationale and System Description

The Integrity-SI Fusion System was designed utilizing time-tested clinical principles of joint fusion. Throughout design the development team focused on these five clinically accepted principles of fusing a joint space: Angle of Approach, Joint Preparation, Graft Application, Joint Compression, and Stability via Mechanical Integration. As a result, the System provides unparalleled focus on creating fusion in the SI joint.

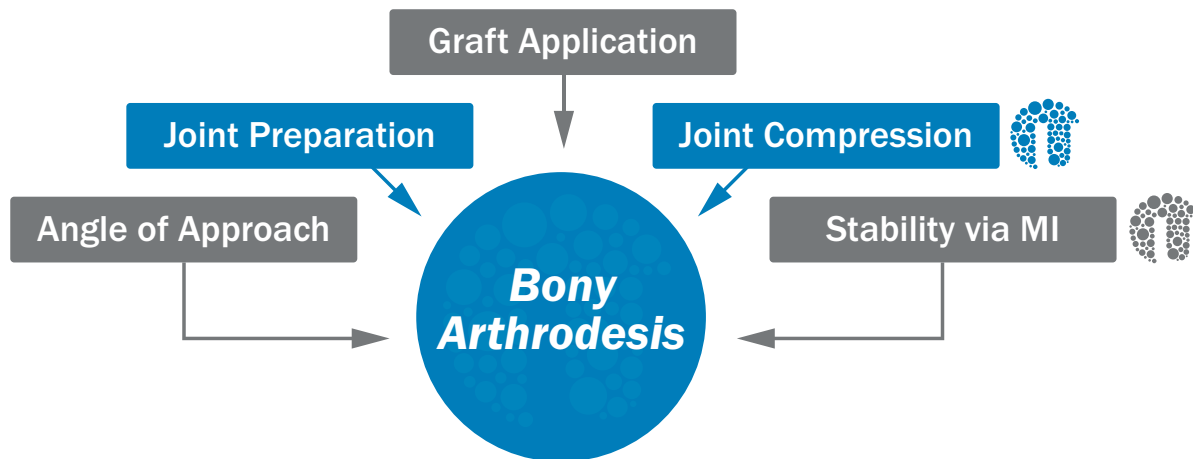

### Enhanced by Mechanical Integration

#### Angle of Approach

A perpendicular approach to the joint with the patient placed in the prone position is used with the Integrity-SI system. The perpendicular approach assures a safe starting position can be attained, allows for easy access to joint for decortication and compression.

#### Joint Preparation

BladeX<sup>®</sup> allows for the surgeon to aggressively decorticate both sides of the SI joint. This aggressive decortication creates bleeding cancellous bone on bleeding cancellous bone, a massive zone within the joint for graft to be applied and fusion to occur.

#### Graft Application

The Integrity-SI instrumentation allows for maximum autograft or allograft to be applied to the fusion zone and within the fusion barrel of the implant. A large fusion zone with significant graft facilitates increased surface area contact across the joint.

#### Joint Compression

A 10mm or 12mm primary implant with a variable angle compressive washer creates compression over the SI joint helping initiate the body's natural healing process.

#### Construct Stability via UnifiMI

Utilizing UnifiMI Technology and the longer working length of the primary implant, the Integrity-SI construct creates initial and long-term stability on both sides of the SI joint due to premium interfacing bone quality.

## Integrity-SI Fusion System Implant List

	Part number	Length (mm)
<b>12mm Anodized SI Implants</b>	202-12040	40
	202-12045	45
	202-12050	50
	202-12055	55
	202-12060	60
	202-12065	65
	202-12070	70
	202-12075	75
	202-12080	80
	202-12085	85
	202-12090	90
	202-12095	95
	202-12100	100
	202-12105	105
	202-12110	110
	<b>10mm Anodized SI Implants</b>	202-10040
202-10045		45
202-10050		50
202-10055		55
202-10060		60
202-10065		65
202-10070		70
202-10075		75
202-10080		80
202-10085		85
202-10090		90
202-10095		95
202-10100		100
202-10105		105
202-10110		110
<b>Optional 6.5mm Biomechanical Fastener</b>		202-65030
	202-65035	35
	202-65040	40
	202-65045	45
	202-65050	50
	202-65055	55
	202-65060	60
	202-65065	65
	202-65070	70
	Note: The 6.5mm fastener can only be used in conjunction with a primary 10mm or 12mm fastener.	

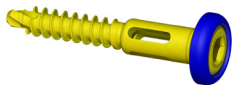

10mm Integrity-SI Fusion Implant



12mm Integrity-SI Fusion Implant

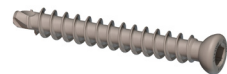

6.5mm Biomechanical Fastener

## Integrity-SI® Fusion System Instrument List

	Part number	Description
<b>BladeX® MIS Decorticator</b>	202-0001	BladeX Cutter
	202-0002	Central Shaft
	202-82038	Blade, 38mm
<b>Guide Wires/Pins</b>	202-80100	2.0mm Guide Pin
	202-80200	3.2mm Guide Pin - long
	202-80201	3.2mm Guide Pin - short
	202-80202	3.2mm Guide Pin - extra long
	202-80300	3.2mm Stabilizing Guide Pin
<b>Drills</b>	202-80403	12mm Drill
	202-80402	7.5mm Drill
	202-80401	6.0mm Drill
	202-80400	4.0mm Drill
<b>Taps</b>	202-1101	6.5mm Tap
	202-1102	10mm Tap
	202-1103	12mm Tap
<b>Cannulas</b>	202-0101	24mm Cannula
<b>12mm Sleeve</b>	202-0102	12mm Sleeve
<b>Impactor</b>	202-1002	Impactor
<b>Dilators</b>	202-0104	12mm Dilator
	202-0105	18mm Dilator
	202-0106	24mm Dilator
<b>Implant Length Gauge</b>	202-0201	Implant Length Gauge
<b>Graft Inserter</b>	202-0301	Graft Inserter
	202-0302	Graft Inserter Ram
<b>Hex Driver</b>	202-0401	Hex Driver - large
	202-0402	Hex Driver - small
<b>Removal tool</b>	202-0501	Removal Tool
<b>Suction Tube</b>	202-0601	Suction Tube
<b>2.0 Wire Guide</b>	202-0701	2.0 Wire Guide
<b>Handles and Tray</b>	202-0801	Inline Ratcheting Handle
	202-0802	Ratcheting T-Handle
	202-0901	Power Adapter
	202-90000	Instrument Tray
	1252-6001	Implant and Blade Tray



\*Integrity-SI Implants are for single use only



75 West 300 N, Suite 150  
 Logan UT, 84321  
 Phone: 1-800-969-0639  
 info@osteocentric.com  
 osteocentric.com